

## POE-SW508G

8-Port 10/100/1000Mbps Ultra High Power Industrial PoE Switch with 2 SFP Uplink



### Outstanding Features

- Ports: Provide 8\*10/100/1000Mbps High Power PoE ports with 2 1000Mbps SFP
- PoE Standard: IEEE802.3af/at/bt Power over Ethernet (PoE) Compliant
- Ultra PoE : 1-4ports support Single PoE output 90W
- Self-adaption: RJ45 port supports 10/100/1000Mbps Auto MDI/MDIX
- Industrial Installation: Din Rail mounting installation
- Wide Application: Designed for Railway, traffic etc some Industrial environment
- Surge protection: Protect the device from lighting surges and others electrical hazards
- Working Temperature: -40 to 75 degrees operating temperature
- Considerate Design: IP40 Industrial enclosure
- Easy to use: Plug and play, No configuration required

### Environmentally Hardened Design

With the **IP40** metal industrial case which provides a high level of immunity against electromagnetic interference and heavy electrical surges, Being able to operate under the temperature range from **-40 to 75 degrees C**, the POE-SW508G can be placed in almost any difficult environment.





## EDual Power input for High Availability Network

Featuring a strong dual power input system with wide-ranging voltages (48V~56V DC) incorporated into customer's automation network to enhance system reliability and uptime which make the installation more flexible and convenient.

## Surge Protection Design

provides contact discharge of  $\pm 8\text{KV}$  DC and air discharge of  $\pm 15\text{KV}$  DC for Ethernet ESD protection. It also supports  $\pm 6\text{KV}$  surge immunity to improve product stability and protects users' networks from devastating ESD attacks, making sure the flow of operation does not fluctuate.



## Specification

Hardware Specifications		
ports	8*10/100/1000BASE-T RJ45 auto-MDI/MDI-X ports 2*1000Mbps SFP Slot	
Connector	Removable 4-pin terminal blockPin 1/2 for Power 1; Pin 3/4 for Power 2	
LED Display	Power Indicator: PWR(green).Network Indicator: Link(yellow) SFP: Green	
Power requirements	48~56V DC	
Installation	DIN-rail kit	
Switch Performance	Backplane bandwidth	20Gbps
	Packet forwarding rate	16.86Mpps
	MAC address	4k
	Flow control Back pressure for half duple. IEEE 802.3x pause frame for full duplex	
Enclosure	IP40 Metal case	
ESD Protection	6KV ESD	
Dimension(W x D x H)	150 × 110 × 50 mm (5.9" × 4.3" × 1.9")	
Weight	0.85 Kg (1.874 lb)	
Power over Ethernet (PoE) Specifications		
Network standard	IEEE802.3i 10 BASE-T IEEE802.3u 100 BASE-TX IEEE802.3ab1000BASE-T IEEE802.3x Flow Control IEEE802.3af Power over Ethernet IEEE802.3at Power over Ethernet IEEE802.3btPower over Ethernet IEEE802.3az EEE	
PoE Standard	IEEE 802.3af Power over Ethernet/PSE IEEE 802.3at Power over Ethernet Plus/PSE IEEE 802.3bt Power over Ethernet Plus+/PSE (1~4 Port)	
PoE Supply Type	12/45(+), 36/78(-) End-span	
PoE Power Output	Per Port 52V DC, 300mA. max. 15.4 watts (IEEE 802.3af) Per Port 52V DC, 600mA. max. 30 watts (IEEE 802.3at) Per Port 56V DC, 1720mA. max. 90watts (IEEE 802.3bt)	
Environment		
Environment specification	Operating temperature: -40℃~75℃, operating humidity: 5%~95% Storage temperature: -40℃~75℃. storage humidity: 5%~95%	

## Installation Models

### Power Terminal

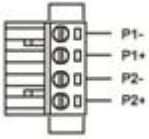

- ◆ 4-pin 3.81mm-spacing plug-in terminal
- ◆ 48V-56VDC wide voltage input
- ◆ P1&P2 dual power input
- ◆ Reverse protection

### Earth Protection

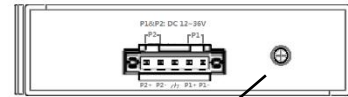

Ground terminal or screw

### Din-Rail

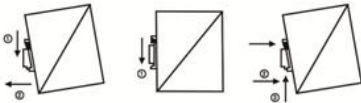

## Mechanical Drawing

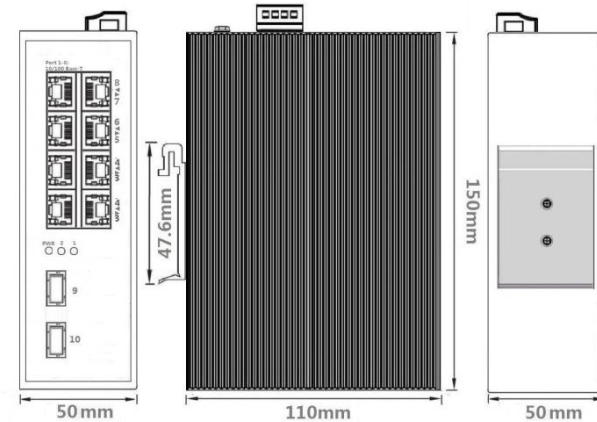

## Applications

